

New Ecodesign Ready Copeland Scroll™ Compressors

Large commercial 20 & 25 hp models for 50 to 400 kW chillers

Innovation at Its Finest

The next generation of Copeland Scroll 20 and 25 hp compressors is built upon more than 25 years of scroll expertise and several years of research. ZP232KZE and ZP292KZE were developed to meet the increased need for more performant and more efficient compressors for the air conditioning market.

They are equipped with VVR technology to deliver the best part-load cooling efficiency, increasing the seasonal efficiency performance (SEER) by 5% compared to the previous generation, which will help OEMs meet the minimum seasonal performance level required by the Ecodesign Directive.

In the future, embedded electronics and internal sensors will bring additional advantages to system manufacturers: thanks to compressor monitoring information, the system controller will be able to optimize system performance significantly, by adjusting the refrigerant circuit in an ultra-precise and fully reliable way.

This range is designed for reversible chillers, rooftop or air handling units with a cooling capacity between 100 and 400 kW. ZP232 and ZP292 have a common compact shell, allowing the easy assembly of multiples with two to three compressors.



ZP Compressor Line-up

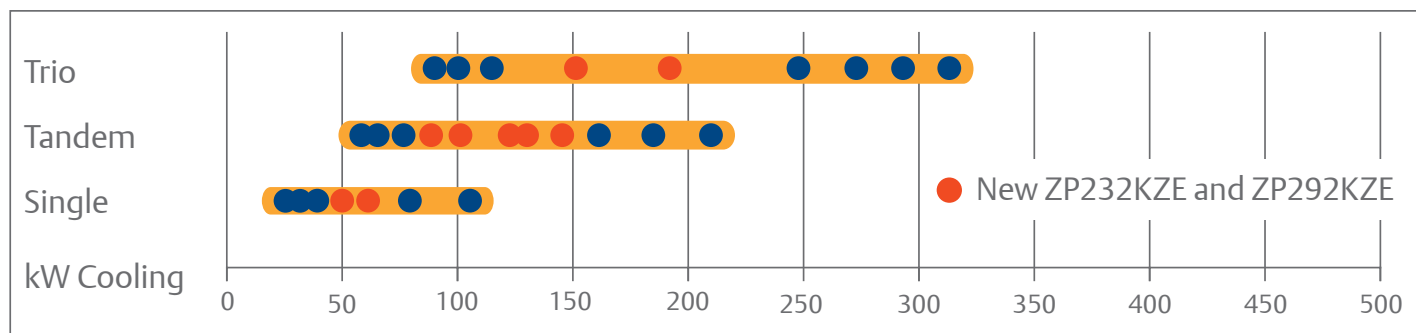

Multiple Copeland Scroll Nominal Cooling kW @ (5/50) EN 12900 - 1 Circuit

Features and Benefits

- **High seasonal performance (SEER)**
5% improved SEER versus previous generation thanks to VVR technology that delivers the best part-load cooling efficiency.
- **Flexibility & reduced complexity**
Wide range of even and uneven tandem and trio assemblies for a full system line-up with a reduced number of compressor models in stock.
- **Enhanced reliability through electronics**
In addition to Copeland proven robustness thanks to axial and radial compliance, the CoreSense™ Communications module provides real time compressor data via RS485 Modbus that is used by the system controller to provide temperature protection. This ensures greater reliability for demanding applications.

ZP232KZE and ZP292KZE are currently available in a standard version with CoreSense, before they are released in a premium version with enhanced electronic features, for future advanced benefits.

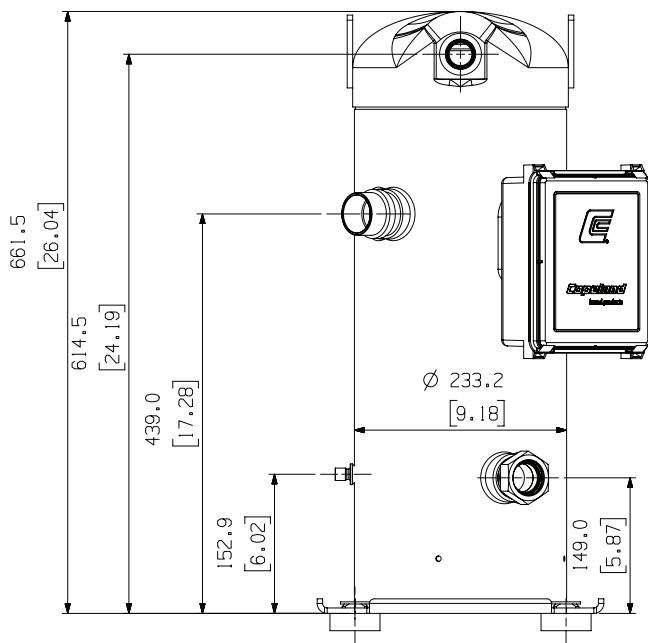

Operating Envelope - R410A

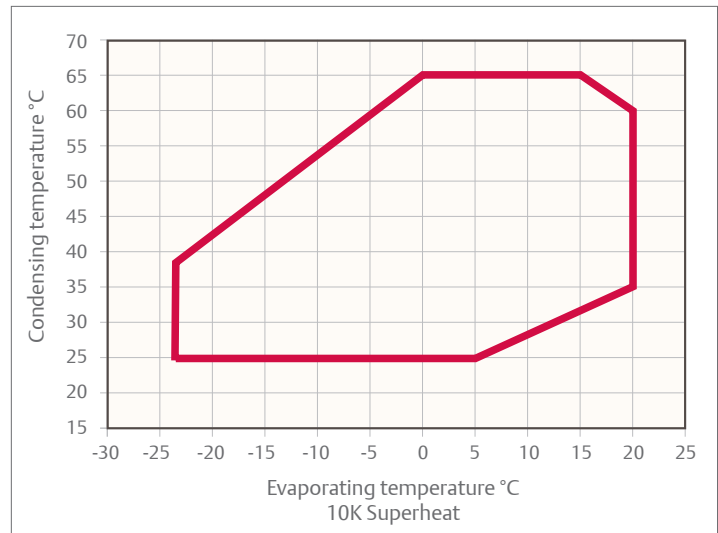

Technical Overview

Model Name	ZP232KZE	ZP292KZE
Nominal HP / TonR	20	25
Capacity (kW) EN12900	50.6	36.5
EER EN12900	3.3	3.3
Part Load SEER Performance	+5% versus previous generation	
R32	Soon	
Height (mm)	661	
Weight (kg)	90	
Suction Diameter (inch)	1-5/8	
Discharge Diameter (inch)	1-1/8	
Shell Diameter (mm)	232	
Discharge Protection	ASTP	
Tandem / Trio Capable	Yes	
Motor Protection	CoreSense™ Communication	
Sound Power (dBa)	83	84

www.EmersonClimate.eu

Emerson Commercial & Residential Solutions

Emerson Climate Technologies GmbH - Pascalstrasse 65 - 52076 Aachen, Germany
Tel. +49 (0) 2408 929 0 - Fax: +49 (0) 2408 929 570 - Internet: www.emersonclimate.eu

The Emerson logo is a trademark and service mark of Emerson Electric Co. Emerson Climate Technologies Inc. is a subsidiary of Emerson Electric Co. Copeland is a registered trademark and Copeland Scroll is a trademark of Emerson Climate Technologies Inc. All other trademarks are property of their respective owners. Emerson Climate Technologies GmbH shall not be liable for errors in the stated capacities, dimensions, etc., as well as typographic errors. Products, specifications, designs and technical data contained in this document are subject to modification by us without prior notice. Illustrations are not binding.
© 2018 Emerson Climate Technologies, Inc.

EMERSON. CONSIDER IT SOLVED.™